

PERSONAL

Create a new internet profile

How to create a new profile for Android devices

Telkom

How do I create a new profile on my Android phone?*



Creating a new profile

(This works best if the above settings are correct and you still cannot connect to the Internet)

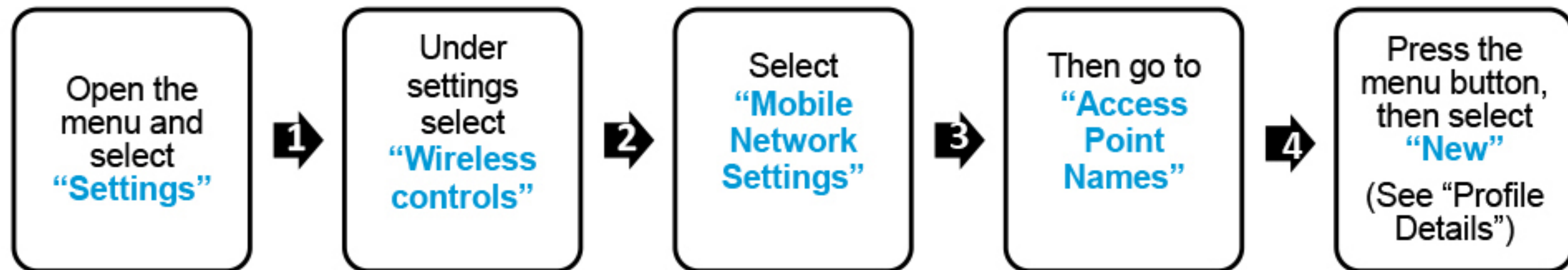

After creating the Internet Access Point Name (APN), create another one for MMS **following the above steps**

Select "Save"

Then go back to the access point menu and **select the profile you just created**

**Please note: some menu options may differ for different Android phones*

How do I create a new profile on my Android phone?*



Profile Details

Name – 8.ta internet, profile1 or anything	APN DNS 2 – 0.0.0.0
APN – internet	Proxy server – blank
Username – leave it blank	Proxy port – blank
Password – leave it blank	Proxy username – blank
Authentication – none	Proxy password – blank
APN DNS 1 – 0.0.0.0	Proxy type – null

**Please note: some menu options may differ for different Android phones*